



Comparison of Efficiency

Note: 1. It may differ under some conditions.

2. Numbers in the charts below are relative values when the capacities of Makita Models are indexed at 100.

1 14.4V Model

Test conditions:

Drove 35mm drywall screws through a plasterboard into Douglas-fir timber.

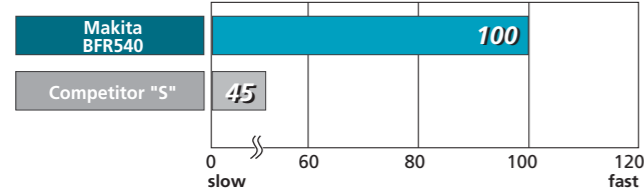

2 18V Model

Test conditions:

Drove 55mm drywall screws through three plasterboard into Douglas-fir timber.

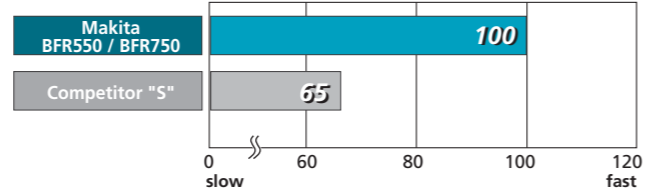

EXTREME STAMINA

Life time work volume **430%**
in comparison with Makita Ni-cd 2.0Ah batteries

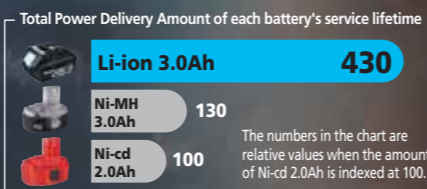

OPTIMUM CHARGING SYSTEM

Makes battery life longer because this charging system takes care of battery by following functions.

- Communicates with individual battery.
- Recognizes ID of battery and its history.
- Analyzes its condition; Battery may have been abused by heat or over-discharging, or weakened by cycle age.
- Knows how to look after each MAKSTAR battery to MAXIMIZE CYCLE LIFE + WORK VOLUME.
- Charges optimum and gentle way with Active 3 Controls; Active Current Control, Active Thermal Control, Active Voltage Control.

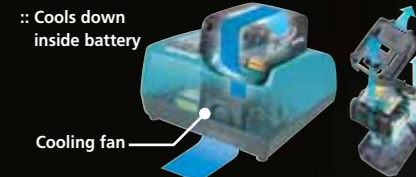
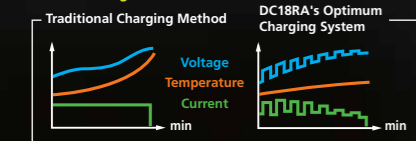

18V Lithium-ion Battery BL1830

14.4V Lithium-ion Battery BL1430



LIGHTWEIGHT & COMPACT

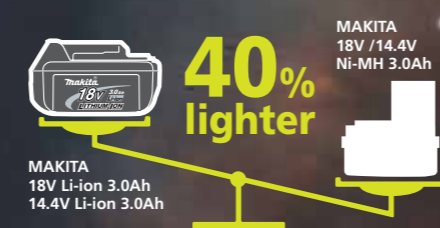

ANYTIME CHARGE
NO MEMORY EFFECT
No discharging required

SHOCK ABSORBING
HEAVY DUTY PACK

LONGTIME STORAGE
LOW SELF DISCHARGE

FIRM HOLDING
MULTI CONTACT

Accessories

Extension handle

Part No. 194500-1



Phillips bit 5pc per pkg.



For Model	Size	Length (mm)	Part No.
BFR540, BFR550	No.2	162	B-10481
BFR750	No.2	182	B-10475

Cordless Auto Feed Screwdriver

BFR540 / BFR550 / BFR750

440

- Reversing
- Carrying Case



	BFR540	BFR550	BFR750
Capacity Drywall screw	4 x 25 to 55mm (5/32" x 1 to 2-3/16")	4 x 25 to 55mm (5/32" x 1 to 2-3/16")	4 x 45 to 75mm (5/32" x 1-3/4 to 2-15/16")
Bit size Hex Shank	6.35mm (1/4")	6.35mm (1/4")	6.35mm (1/4")
No load speed (rpm)	4,000	4,000	4,000
Dimensions (L x W x H)	424 x 80 x 238mm (16-3/4" x 3-1/8" x 9-3/8")	424 x 80 x 238mm (16-3/4" x 3-1/8" x 9-3/8")	464 x 80 x 238mm (18-1/4" x 3-1/8" x 9-3/8")
Net weight	2.1kg (4.6lbs)	2.3kg (5.0lbs)	2.3kg (5.0lbs)
Voltage	14.4V	18V	18V

Standard Equipment
Bit (3pcs.)

Items of standard equipment and specifications may differ by country or area.

Makita Corporation

3-11-8 Sumiyoshi-cho, Anjo, Aichi, 446-8502 Japan

PRINTED IN JAPAN Z15216-2 2007-07



Satisfy Professional's Needs

Cordless Auto Feed Screwdriver

BFR540

14.4V 3.0Ah LITHIUM-ION

BFR550 / BFR750

18V 3.0Ah LITHIUM-ION

Quick Shot!

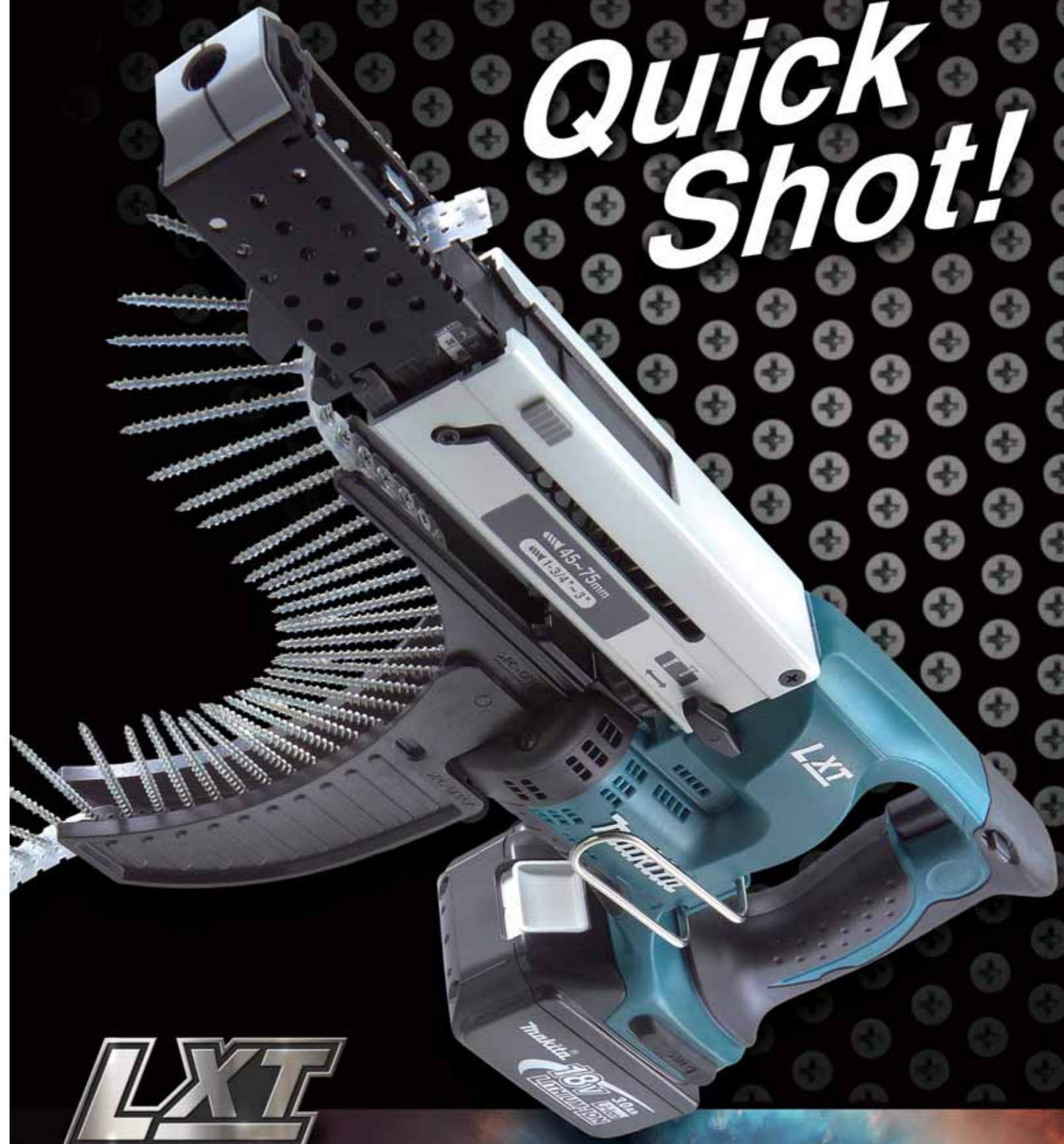

Lithium-ion eXtreme Technology

More Reliable Casing Attachment



Stopper base with anti-tilt device for preventing screws from swaying

Indicator line for feeding position

Adjustable Stopper Base with 7 settings for different screw lengths

Sturdy Aluminum Casing

Casing can be removed/ installed without tool.

Reverse switch
Operable by One Hand

Rubber cap
securely fixed to Stopper
Base for accurate positioning
and preventing slip

Hook
attachable
to both sides

LXT
LITHIUM-ION



Accept screw length up to 55mm

424mm (16-3/4")

BFR540
4,000rpm

Capacity:
4mm X 25mm to 55mm
(5/32" X 1" to 2-3/16")

14.4V 3.0Ah
LITHIUM-ION

Accept screw length up to 55mm

424mm (16-3/4")

BFR550
4,000rpm

Capacity:
4mm X 25mm to 55mm
(5/32" X 1" to 2-3/16")

18V 3.0Ah
LITHIUM-ION

Accept screw length up to 75mm

464mm (18-1/4")

BFR750
4,000rpm

Capacity:
4mm X **45mm to 75mm**
(5/32" X 1-3/4" to 2-15/16")

18V 3.0Ah
LITHIUM-ION

Quick Shooting

with Makita's New Silent Clutch

Our New Silent Clutch features extremely high durability while ensuring high operation efficiency with direct drive transmission in reverse rotation.

Less noise at the end of driving process

The utmost durable clutch

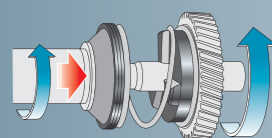

When the bit pushes screw, synchronized rotation starts for smooth engagement.



Anti-tilt device
for accurate positioning
and preventing swaying



Dust-proof construction
for smooth sliding action
Guide rail is provided for
smooth sliding.



Ergonomically designed
rubberized grip
Provides more control
and comfort.

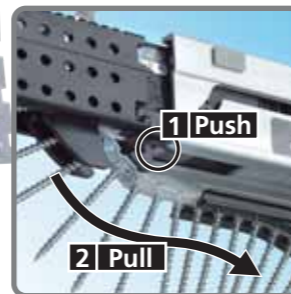

Screw strip can be removed
also in the direction of the
arrow by pushing button.

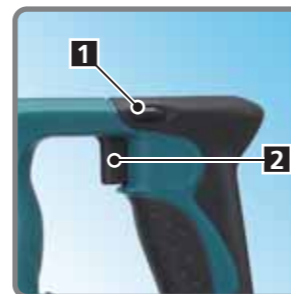

1 Reverse Switch
Operable by One Hand
2 Lock-On Button
for Continuous Operation



Screw Guide
/// Designed to prevent collated
screw strip from getting tangled
/// Foldable for easy transport
and storage